



UNEP Finance Initiative

UNEP FI Portal



Explore New Banking Portal Features

The new functionalities in the Portal are designed to enhance your membership experience

Now you can use the Portal to:

- **View your institution's engagement profile**, including participation in global and regional activities, your contacts, and communications received
- **Easily request to participate in workstreams, pilots, and communities of practice** through an automated system
- **Easily access region-specific opportunities**
- **Manage contact information and communication preferences** to ensure the right people in your organization receive relevant updates

Click [here](#) to navigate to the Portal, create your personal account and explore its current functionality

SIGN IN

Fill in your email address to proceed:

Email

Continue

2025© UNEP FI

[About Us](#) [Contact Support](#)

UN environment programme | finance initiative

THE UNEP FI PORTAL

A data management solution, streamlining data collection, integration, while fostering collaboration and informed decision-making at **UNEP FI**.

<https://portal.unepfi.org/login>

Available supporting material

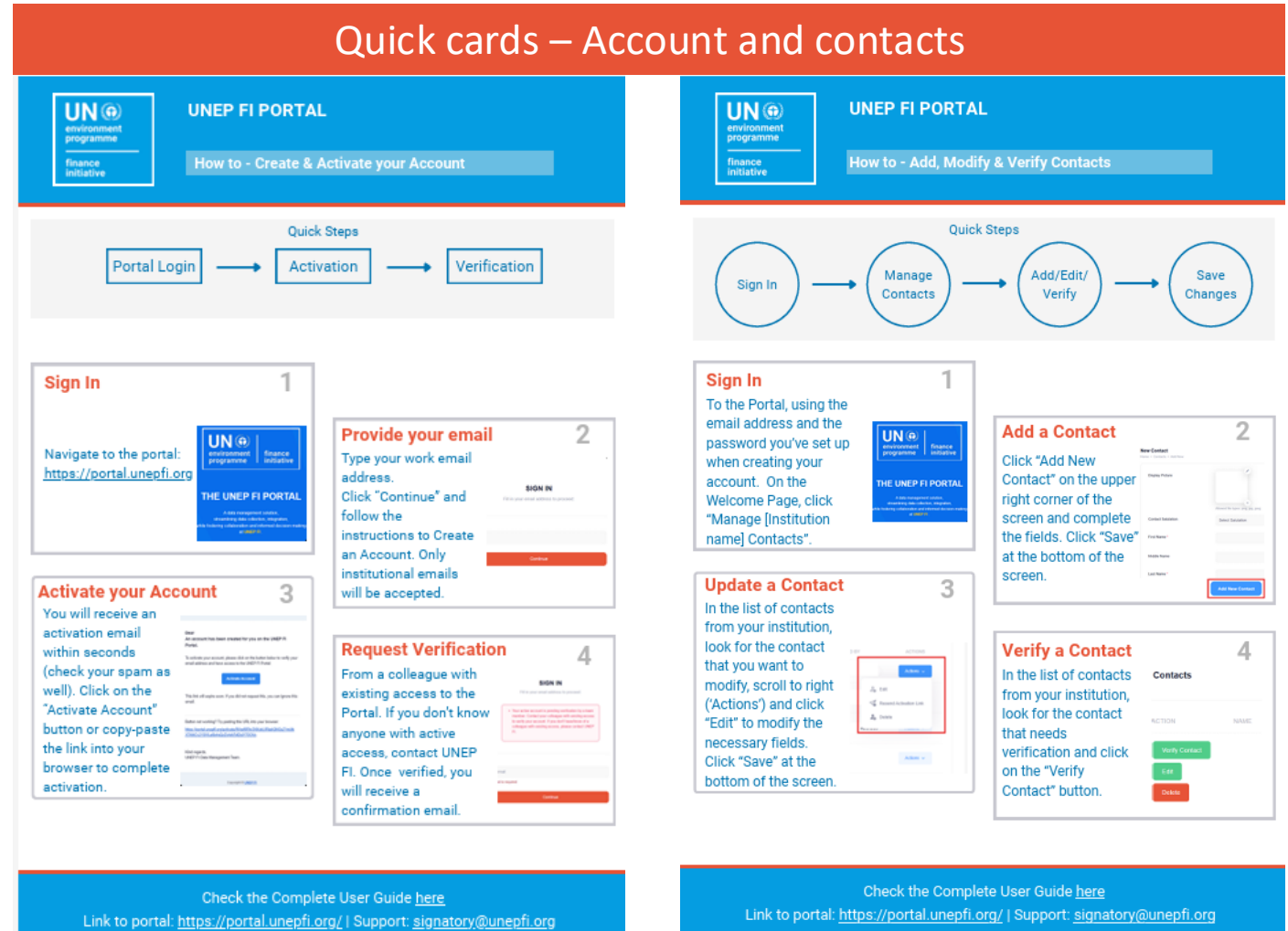
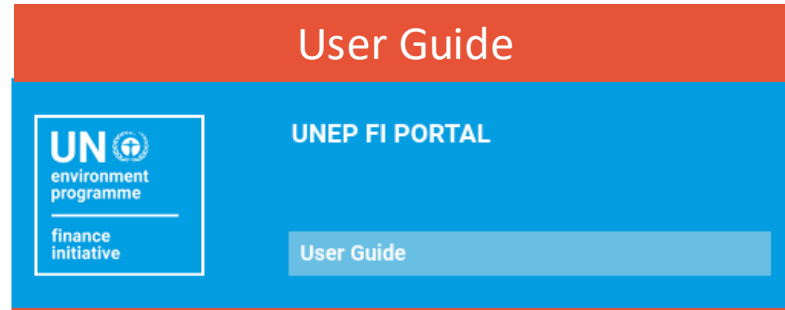

Executive Summary

The UNEP FI Portal (the Portal) is a self-service platform that allows UNEP FI members to view and manage their institution's profile and engagement information, to manage contacts directly and sign up for activities and programs.

Access and Functionalities

The Portal is accessible through the [UNEP FI Members Area](#) or directly at this link [here](https://portal.unepfi.org), allowing members to:

- View your institution's profile and engagement
- View and request to join activities
- Manage contacts' information
- Manage your communication preferences.

By accessing these resources through one integrated location, you can streamline your experience, stay organized, and engage more effectively with the resources and opportunities available.

Staff from all UNEP FI members with a valid institutional address can register to use the Portal.

Access User Guide [here](#)

Access this card here

Access this card here

[unepfi.org](https://portal.unepfi.org) | 3

Available supporting material

Quick cards – Engagement gateway

UNEP FI PORTAL Engagement Gateway

Sign up for Global Activities

Quick Steps

Portal Login → Explore Activities → Request to Join

Sign In 1

To the Portal [here](#), using the email address and the password you've set up when creating your account.

Select 'Sign Up to Global Activities' 2

Under the Engagement Gateway section, click on "Sign up to Global Activities" to access the catalogue of activities your institution is/has participated in and to enroll in new activities.

Explore the Global Activities 3

Explore the catalogue of Global Activities available and click on "Request to Join" to enroll in your preferred activity.

Submit Request 4

Select the Main Participant for the activity. You can also include "Other participants". Make sure the relevant people are registered as contacts. Then click 'Submit'.

Check the Complete User Guide [here](#)

Link to portal: <https://portal.unepfi.org/> | Support: signatory@unepfi.org

Access this card here

UNEP FI PORTAL Engagement Gateway

View your engagement with UNEP FI

Quick Steps

Portal Login → View Engagement Profile → Engagement Info

Sign In 1

To the Portal [here](#), using the email address and the password you've set up when creating your account.

Select View Profile 2

On the Homepage, Under the Engagement Gateway section, click on "View [Institution's name] profile" to access your institution's engagement profile.

View Engagement Profile 3

Your engagement profile is organised into six main sections, accessible through the navigation header: Membership, Global Activities, Region-specific support, Review Process, Contacts and Communications.

Explore 4

The profile sections such as global activities, region support, progress statements, Review, Comms. etc.

Check the Complete User Guide [here](#)

Link to portal: <https://portal.unepfi.org/> | Support: signatory@unepfi.org

Access this card here